

DIN 931 similar to ISO 4014

Hexagon head bolts

Hexagon head | external hex | with body

Steel 5.6 | bright | Cr(VI)-free | Metric thread

Further information: DIN-standard has been withdrawn | changed spanner widths for M10, M12, M14 and M22 | screws can be paired with a 6h tolerance-compliant female thread

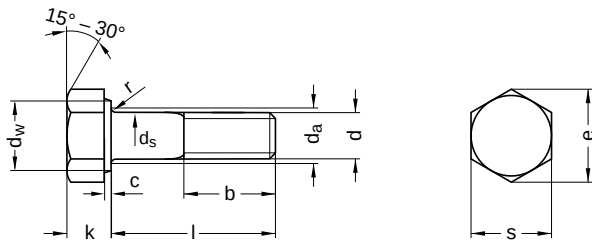

Diameter (d)	b			c		d _a	d _s	d _w	e	k		r	s		Pitch (P)
	longer than 200	l up to 125	l up to 200	min.	max.	max.	max.	min.	min.	min.	max.	min.	max.	min.	max.
M 12	49	30	36	0.15	0.6	13.7	12	17.4	21.10	7.32	7.68	0.6	19	18.67	1.75
M 16	57	38	44	0.20	0.8	17.7	16	22.0	26.17	9.71	10.29	0.6	27	26.16	2.00
M 20	65	46	52	0.20	0.8	22.4	20	27.7	32.95	12.15	12.85	0.8	30	29.16	2.50
M 24	73	54	60	0.20	0.8	26.4	24	33.2	39.55	14.65	15.35	0.8	36	15.39	3.00
M 27	79	60	66	0.20	0.8	30.4	27	38.0	45.20	16.65	17.35	1.0	41	40.00	3.00
M 30	85	66	72	0.20	0.8	33.4	30	42.7	50.85	18.28	19.12	1.0	46	45.00	3.50
M 33	91	72	78	0.20	0.8	36.4	33	46.6	55.37	20.58	21.42	1.0	50	49.00	3.50
M 36	97	78	84	0.20	0.8	39.4	36	51.1	60.79	22.08	22.92	1.0	55	53.80	4.00

nominal size	Length (l)	
	min.	max.
45	44.50	45.50
50	49.50	50.50
55	54.40	55.60
60	59.40	60.60
65	64.40	65.60
70	69.40	70.60

nominal size	Length (l)	
	min.	max.
75	74.40	75.60
80	79.40	80.60
90	88.25	91.75
100	98.25	100.75
110	108.25	111.75
120	118.25	121.75

nominal size	Length (l)	
	min.	max.
130	128.00	132.00
140	138.00	142.00
150	148.00	152.00
160	158.00	162.00
180	178.00	182.00
200	197.70	202.30

All technical data refer to the measure mm

