

DIN 931 similar to ISO 4014

Hexagon head bolts

Hexagon head | external hex | with body

Steel 8.8 | bright | Cr(VI)-free | Metric thread

Further information: DIN-standard has been withdrawn | changed spanner widths for M10, M12, M14 and M22 | screws can be paired with a 6h tolerance-compliant female thread

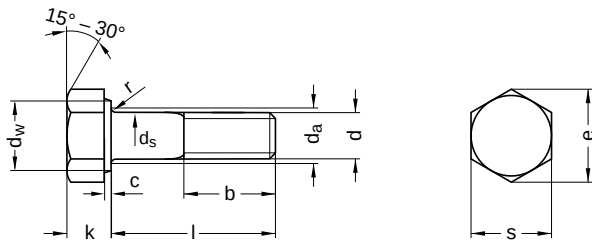

Diameter (d)	b			c		d _a max.	d _s max.
	longer than 200	l up to 125	l up to 200	min.	max.		
M 4	20	14	20	0.15	0.4	4.7	4
M 5	35	16	22	0.15	0.5	5.7	5
M 6	37	18	24	0.15	0.5	6.8	6
M 8	41	22	28	0.15	0.6	9.2	8
M 10	45	26	32	0.15	0.6	11.2	10
M 12	49	30	36	0.15	0.6	13.7	12
M 14	53	34	40	0.15	0.6	15.7	14
M 16	57	38	44	0.20	0.8	17.7	16
M 18	61	42	48	0.20	0.8	20.2	18
M 20	65	46	52	0.20	0.8	22.4	20
M 22	69	50	56	0.20	0.8	24.4	22
M 24	73	54	60	0.20	0.8	26.4	24
M 27	79	60	66	0.20	0.8	30.4	27
M 30	85	66	72	0.20	0.8	33.4	30
M 33	91	72	78	0.20	0.8	36.4	33
M 36	97	78	84	0.20	0.8	39.4	36

Diameter (d)	d _w min.	e min.	k		r min.	s		Pitch (P)
			min.	max.		max.	min.	
M 4	5.9	7.66	2.68	2.92	0.20	7	6.78	0.70
M 5	6.9	8.79	3.35	3.65	0.20	8	7.79	0.80
M 6	8.9	11.05	3.85	4.15	0.25	10	9.78	1.00
M 8	11.6	14.38	5.15	5.45	0.40	13	12.73	1.25
M 10	15.6	18.90	6.22	6.58	0.40	17	16.73	1.50
M 12	17.4	21.10	7.32	7.68	0.60	19	18.67	1.75
M 14	20.5	24.49	8.62	8.98	0.60	22	21.67	2.00
M 16	22.0	26.17	9.71	10.29	0.60	27	26.16	2.00
M 18	24.8	29.56	11.15	11.85	0.60	27	26.16	2.50
M 20	27.7	32.95	12.15	12.85	0.80	30	29.16	2.50
M 22	29.5	35.03	13.65	14.35	0.80	32	31.00	2.50
M 24	33.2	39.55	14.65	15.35	0.80	36	15.39	3.00

All technical data refer to the measure mm



DIN 931 similar to ISO 4014

Hexagon head bolts

Hexagon head | external hex | with body

Steel 8.8 | bright | Cr(VI)-free | Metric thread

Diameter (d)	d _w	e	k		r	s		Pitch (P)
	min.	min.	min.	max.	min.	max.	min.	
M 27	38.0	45.20	16.65	17.35	1.00	41	40.00	3.00
M 30	42.7	50.85	18.28	19.12	1.00	46	45.00	3.50
M 33	46.6	55.37	20.58	21.42	1.00	50	49.00	3.50
M 36	51.1	60.79	22.08	22.92	1.00	55	53.80	4.00

nominal size	Length (l)	
	min.	max.
25	24.58	25.42
30	29.58	30.42
35	34.50	35.50
40	39.50	40.50
45	44.50	45.50
50	49.50	50.50
55	54.40	55.60
60	59.40	60.60
65	64.40	65.60
70	69.40	70.60
75	74.40	75.60
80	79.40	80.60
85	83.25	86.75
90	88.25	91.75
95	93.25	96.75
100	98.25	100.75
105	103.25	106.75
110	108.25	111.75
115	113.25	116.75
120	118.25	121.75
125	123.00	127.00
130	128.00	132.00

nominal size	Length (l)	
	min.	max.
140	138.00	142.00
150	148.00	152.00
160	158.00	162.00
170	168.00	172.00
180	178.00	182.00
190	187.70	192.30
200	197.70	202.30
210	207.70	212.30
220	217.70	222.30
230	227.70	232.30
240	237.70	242.30
250	247.70	252.30
260	257.40	262.60
270	267.40	272.60
280	277.40	282.60
290	287.40	292.60
300	297.40	302.60
310	307.40	312.60
320	317.15	322.85
330	327.15	332.85
340	337.15	342.85
350	347.15	352.85

nominal size	Length (l)	
	min.	max.
360	357.15	362.85
370	367.15	372.85
380	377.15	382.85
390	387.15	392.85
400	397.15	402.85
410	406.85	413.15
420	416.85	423.15
430	426.85	433.15
440	436.85	443.15
450	446.85	453.15
460	456.85	463.15
480	476.85	483.15
500	496.85	503.15
520	516.85	523.15
540	536.85	543.15
560	556.85	563.15
580	576.85	583.15
600	596.85	603.15
620	616.85	623.15
640	636.85	643.15
660	656.85	663.15
680	676.85	683.15

All technical data refer to the measure mm

