

DIN 934 similar to ISO 4032

Hexagon nuts

External hex

Steel 8 | zinc-plated | Cr(VI)-free | Metric thread

Further information: DIN-standard has been withdrawn | changed spanner widths for M10, M12, M14 and M22 | the fine thread has been transferred to ISO 8673

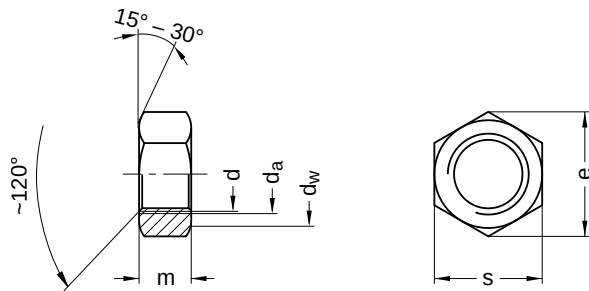

| Diameter (d) | d _a | | d _w min. | e min. | m | | s | | Pitch (P) |
|-----------------|----------------|-------|------------------------|-----------|-------|------|-------|------|--------------|
| | min. | max. | | | min. | max. | min. | max. | |
| M 2 | 2.0 | 2.30 | 3.2 | 4.32 | 1.35 | 1.6 | 3.82 | 4.0 | 0.40 |
| M 2.5 | 2.5 | 2.50 | 4.1 | 5.45 | 1.75 | 2.0 | 4.82 | 5.0 | 0.45 |
| M 3 | 3.0 | 3.45 | 4.5 | 6.01 | 2.15 | 2.4 | 5.32 | 5.5 | 0.50 |
| M 4 | 4.0 | 4.60 | 5.8 | 7.66 | 2.90 | 3.2 | 6.78 | 7.0 | 0.70 |
| M 5 | 5.0 | 5.75 | 6.8 | 8.79 | 3.70 | 4.0 | 7.78 | 8.0 | 0.80 |
| M 6 | 6.0 | 6.75 | 8.8 | 11.05 | 4.70 | 5.0 | 9.78 | 10.0 | 1.00 |
| M 7 | 7.0 | 7.75 | 9.5 | 12.12 | 5.20 | 5.5 | 10.73 | 11.0 | 1.00 |
| M 8 | 8.0 | 8.75 | 11.3 | 14.38 | 6.14 | 6.5 | 12.73 | 13.0 | 1.25 |
| M 10 | 10.0 | 10.80 | 15.3 | 18.90 | 7.64 | 8.0 | 16.73 | 17.0 | 1.50 |
| M 12 | 12.0 | 13.00 | 17.2 | 21.10 | 9.64 | 10.0 | 18.67 | 19.0 | 1.75 |
| M 14 | 14.0 | 15.10 | 20.2 | 24.49 | 10.30 | 11.0 | 21.67 | 22.0 | 2.00 |
| M 16 | 16.0 | 17.30 | 22.2 | 26.75 | 12.30 | 13.0 | 23.67 | 24.0 | 2.00 |
| M 18 | 18.0 | 19.50 | 25.3 | 29.56 | 14.30 | 15.0 | 26.16 | 27.0 | 2.50 |
| M 20 | 20.0 | 21.60 | 28.2 | 32.95 | 14.90 | 16.0 | 29.16 | 30.0 | 2.50 |
| M 22 | 22.0 | 23.70 | 29.5 | 35.03 | 16.90 | 18.0 | 31.00 | 32.0 | 2.50 |
| M 24 | 24.0 | 25.90 | 33.2 | 39.55 | 17.70 | 19.0 | 35.00 | 36.0 | 3.00 |
| M 27 | 27.0 | 29.10 | 38.0 | 45.20 | 20.70 | 22.0 | 40.00 | 41.0 | 3.00 |
| M 30 | 30.0 | 32.40 | 42.7 | 50.65 | 22.70 | 24.0 | 45.00 | 46.0 | 3.50 |
| M 33 | 33.0 | 35.60 | 46.6 | 55.37 | 24.70 | 26.0 | 49.00 | 50.0 | 3.50 |
| M 36 | 36.0 | 38.90 | 51.1 | 60.79 | 27.40 | 29.0 | 53.80 | 55.0 | 4.00 |
| M 39 | 39.0 | 42.10 | 55.9 | 66.44 | 29.40 | 31.0 | 58.80 | 60.0 | 4.00 |
| M 42 | 42.0 | 45.40 | 60.6 | 71.30 | 32.40 | 34.0 | 63.10 | 65.0 | 4.50 |
| M 45 | 45.0 | 48.60 | 64.7 | 76.95 | 34.40 | 36.0 | 68.10 | 70.0 | 4.50 |
| M 48 | 48.0 | 51.80 | 69.4 | 82.60 | 36.40 | 38.0 | 73.10 | 75.0 | 5.00 |

All technical data refer to the measure mm

