

**DIN 934** similar to ISO 4032

## Hexagon nuts

External hex

Steel 8 | black zinc-plated | Contains Cr(VI) | Metric thread

Further information: DIN-standard has been withdrawn | changed spanner widths for M10, M12, M14 and M22 | the fine thread has been transferred to ISO 8673

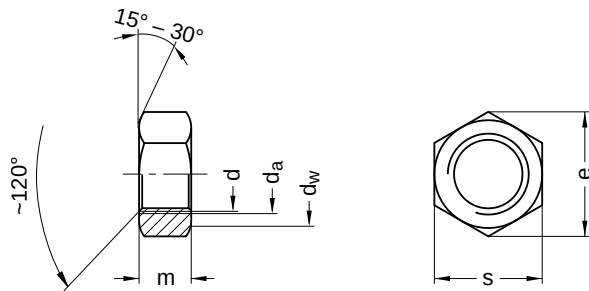

Diameter (d)	d <sub>a</sub>		d <sub>w</sub> min.	e min.	m		s		Pitch (P)
	min.	max.			min.	max.	min.	max.	
M 4	4	4.60	5.8	7.66	2.90	3.2	6.78	7	0.70
M 6	6	6.75	8.8	11.05	4.70	5.0	9.78	10	1.00
M 8	8	8.75	11.3	14.38	6.14	6.5	12.73	13	1.25
M 10	10	10.80	15.3	18.90	7.64	8.0	16.73	17	1.50
M 12	12	13.00	17.2	21.10	9.64	10.0	18.67	19	1.75
M 14	14	15.10	20.2	24.49	10.30	11.0	21.67	22	2.00

All technical data refer to the measure mm

