

MOLD COUPLING SOCKETS / PLUGS

—EU TYPE—

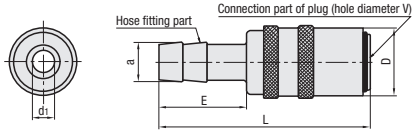

For hose installation
C—F120—MZSHM
 (Heat resistance 120°C • without self-sealing valve)
C—F120—MZSH
 (Heat resistance 120°C • without self-sealing valve)



M Brass

Applicable plug	Connection part of plug		L	Inner hole d1	Hose fitting part		Part No.	
	V	D			a	E	Type	No.
Couplers for cooling-water - front end diameter V=13.5	13.5	22	62	9	14	25	For hose installation C—F120—MZSHM	4
Couplers for cooling-water - front end diameter V=9	9	17	53	6	10	22	For hose installation C—F120—MZSH	3

⚠ C—F120—MZSHM, C—F120—MZSH do not have valve. Please confirm water temperature and pressure before detachment.



For hose installation - L type
C—F120—MZSHLM
 (Heat resistance 120°C • without self-sealing valve)
C—F120—MZSHL
 (Heat resistance 120°C • without self-sealing valve)

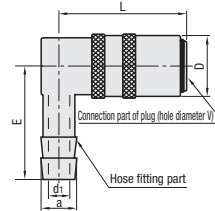

M Brass

Applicable plug	Connection part of plug		L (reference)	Inner hole d1	Hose fitting part		Part No.	
	V	D			a	E (reference)	Type	No.
Couplers for cooling-water - front end diameter V=13.5	13.5	22	(44)	9	14	(38)	For hose installation - L type C—F120—MZSHLM	4
Couplers for cooling-water - front end diameter V=9	9	17	(36)	6	10	(32)	For hose installation - L type C—F120—MZSHL	3

⚠ C—F120—MZSHLM, C—F120—MZSHL do not have valve. Please confirm water temperature and pressure before detachment.



C—JPZHM
C—JPZH

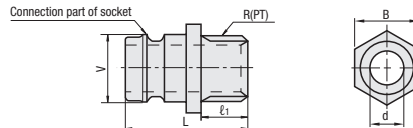

M Brass

Applicable socket	Connection part of socket V	L	B	Inner hole d	Taper external thread R(PT)	l ₁	Part No.	
							Type	No.
Couplers for cooling-water series - socket hole diameter V=13.5	13.5	26	15	6	1/8	9	C—JPZHM	1
								2
								3
Couplers for cooling-water series - socket hole diameter V=9	9	24	11	6	1/8	7	C—JPZH	1
								2
								3



C—LJPZHM
 (outer hexagonal shoulder long type)
C—LJPZH
 (outer hexagonal shoulder long type)

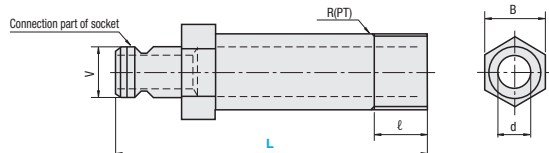

M Brass

Applicable socket	Connection part of socket V	B	Inner hole d	Taper external thread R(PT)	l	Part No.		
						Type	No.	L
Couplers for cooling-water series - socket hole diameter V=13.5	13.5	15	6	1/8	10	C—LJPZHM	1	50 100
							2	50 100
							3	100
Couplers for cooling-water series - socket hole diameter V=9	9	11	6	1/8	10	C—LJPZH	1	50 100
							2	50 100
							3	100



Order Part No. — L
C—F120—MZSHM 4
C—JPZHM 2
C—LJPZHM 2 — 100



Days to Ship
 •C—JPZH C—JPZHM
 Stock



•Other
6 Days



Price

Order / Quote:
 WOS: <https://in.misumi-ec.com/>
 TEL:+91-124-468-8800 E-mail:cs@misumi.co.in