



CAM STROKE PLATES

— 30° TYPE —



CAM STROKE PLATES

— 15° TYPE —



RoHS

CS30W (Copper alloy type)

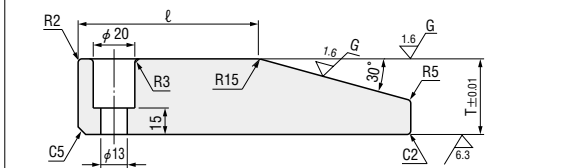
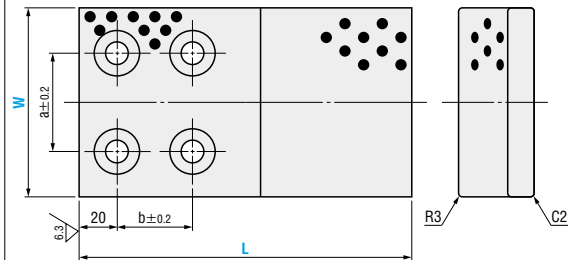

■ Copper alloy
Special solid lubricant (embedded)

CS30F (Steel type) CS30FN (Steel type without oil groove)

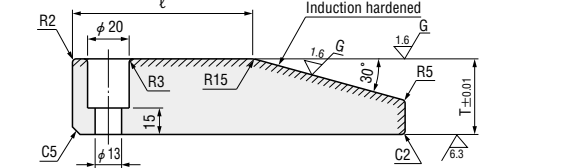
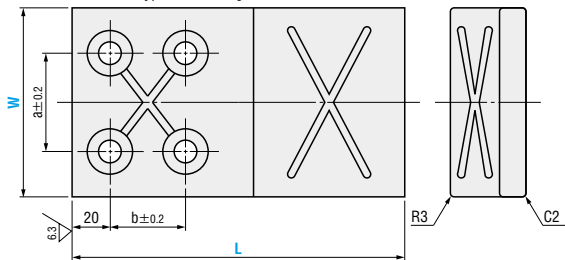

■ S45C
■ 55HRC~
(Induction hardened)

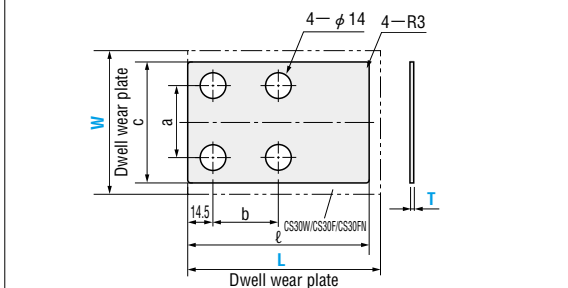

Shim for cam dwell wear plates

c	ℓ	a	b	Catalog No.	Nominal (cam dwell wear plate)		Thickness T
					W	L	
65	120	40	50	SPCSP	75	130	0.05 0.1
	140		45		150		
90	120	60	50		100	130	
	140		45		150		
115	120	85	50		125	130	
	140		45		150		
140	120	110	50	150	130		
	140		45	150			

⊙ Only L=130 and 150

Order	Catalog No.	W	L	T
☎	CS30W	100	200	
☎	SPCSP	75	130	0.1

☎ Days to Ship **Quotation**

P Price **Quotation**

EX Example

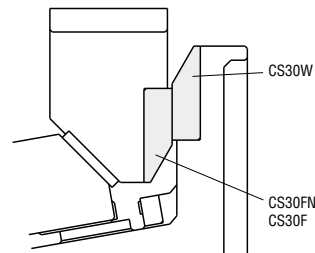

T	ℓ	a	b	Catalog No.	W	L	
30	95	40	50	CS30W	75	130	
45	90		45			150	
60	120		75			170	
30	95	60	50		CS30F	100	130
45	90		45				150
60	120		75				170
30	95	85	50	CS30FN		125	130
45	90		45				150
60	120		75				170
30	95	110	50		CS30F	150	130
45	90		45				150
60	120		75				200



RoHS

CS15W (Copper alloy type)

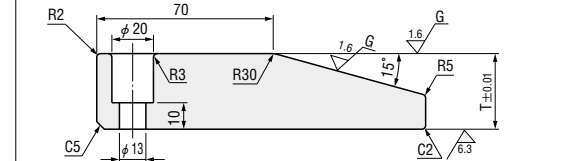
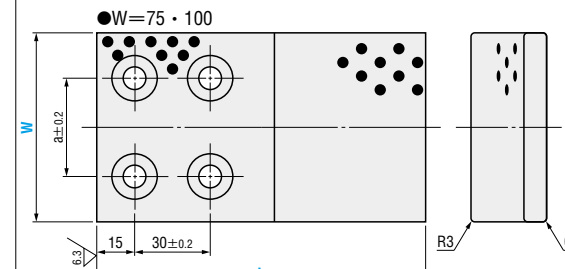
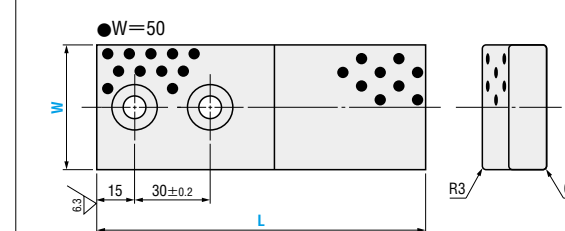

■ Copper alloy
Special solid lubricant (embedded)

CS15F (Steel type) CS15FN (Steel type without oil groove)

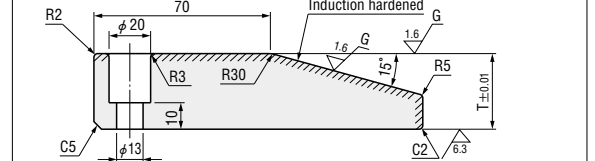
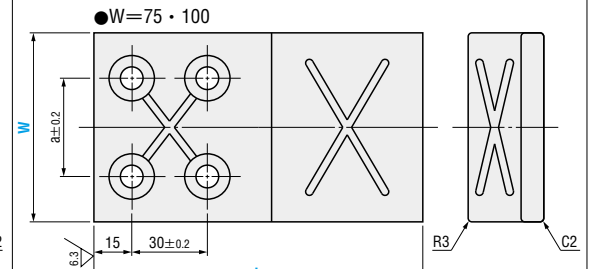
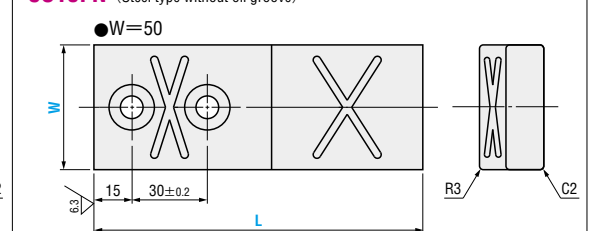

■ S45C
■ 55HRC~
(Induction hardened)

T	a	Catalog No.	W	L	
25	—	CS15W	50	110	
30				130	
35				150	
25	40		CS15F	75	110
30					130
35					150
25	60	CS15FN		100	110
30					130
35					150

Order	Catalog No.	W	L
☎	CS15W	50	110

☎ Days to Ship

Quotation

P Price

Quotation

EX Example

