

## Spring Plungers with internal hexagon

### 22060.0403

#### Product Description

Spring plungers can be used for locating or for applying pressure, as a detent or for ejection.



#### Material

##### Body

- Stainless steel 1.4305

##### Spring

- stainless steel

#### Assembly

Spring plungers can be mounted and removed by means of the slot or internal hexagon. Please use a special assembly tool for mounting with a slot (pin side).

#### Characteristic

Standard spring load: no marking

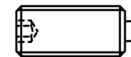

Standard spring load

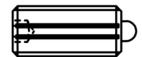

Heavy spring load

#### More information

#### Notes

Special types on request.  
Spring plungers are specially tested for spring range and forces.

#### References

Thread lock on request, please refer to appendix - Technical Data -

#### Further products

- Spring Plungers, with internal hexagon and seal

#### Drawing

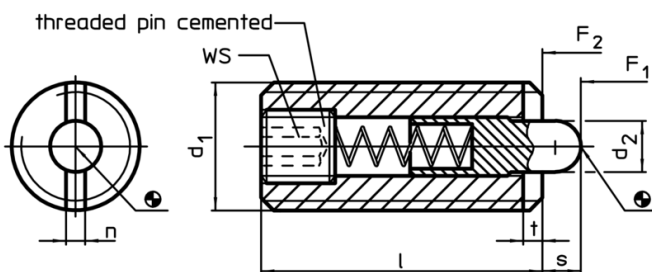

#### Order information

Dimensions					WS	Stroke s	Spring load <sup>1)</sup>		max. [°C]	[g]	Art. No.
d <sub>1</sub>	d <sub>2</sub>	l	n	t			F <sub>1</sub> ~	F <sub>2</sub> ~			
[mm]					[mm]	[mm]	[kN]		[°C]	[g]	
stainless steel, standard spring load											
M3	1	12	0,4	0,5	0,7	1	2	4	250	0,4	22060.0403

<sup>1)</sup> statistical average value

Application example

