

Spring Plungers· smooth
22070.0106

Product Description



Especially designed for the use in tool-making.
Usable as ejection pins and spring stops.
It is impossible for the complete spring plunger or any of its individual parts to come out of the retaining bore.

Material

Pin
• Steel, case-hardened, blackened

Body
• Stainless steel 1.4305

Spring
• stainless steel

More information

Notes

Special types on request.
Spring plungers are specially tested for spring range and forces.

Drawing

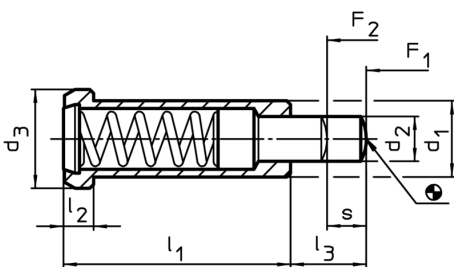

Order information

Dimensions						Stroke s [mm]	Spring load ¹⁾		max. [°C]	Location hole H7 [mm]	[g]	Art. No.
d_1 -0,05	d_2	d_3	l_1	l_2	l_3		F_1 ~ [N]	F_2 ~ [N]				
stainless steel, standard spring load												
6	2,7	8	20	3,2	6	3,5	10	22	250	6	4,2	22070.0106

¹⁾ statistical average value

Application example

