

Spring Plungers• smooth

22070.0108



Product Description

Especially designed for the use in tool-making.
Usable as ejection pins and spring stops.

It is impossible for the complete spring plunger or any of its individual parts to come out of the retaining bore.

Material

Pin

- Steel, case-hardened, blackened

Body

- Stainless steel 1.4305

Spring

- stainless steel

More information

Notes

Special types on request.

Spring plungers are specially tested for spring range and forces.

Drawing

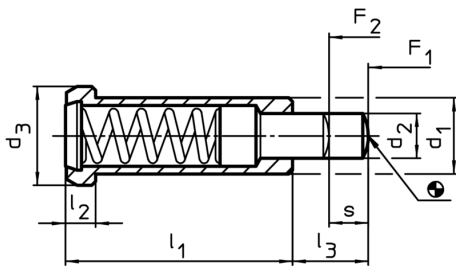

Order information

Dimensions						Stroke s	Spring load ¹⁾		max.	Location hole H7		Art. No.
d ₁	d ₂	d ₃	l ₁	l ₂	l ₃		F ₁ ~	F ₂ ~				
-0,05						[mm]	[N]	[N]	[°C]	[mm]	[g]	
stainless steel, standard spring load												
8	3,9	10	24	3,2	8	4,5	30	88	250	8	7,7	22070.0108

¹⁾ statistical average value

Application example

