

Spring Plungers· smooth

22070.0112

Product Description



Especially designed for the use in tool-making.
Usable as ejection pins and spring stops.
It is impossible for the complete spring plunger or any of its individual parts to come out of the retaining bore.

Material

Pin
• Steel, case-hardened, blackened

Body
• Stainless steel 1.4305

Spring
• stainless steel

More information

Notes

Special types on request.
Spring plungers are specially tested for spring range and forces.

Drawing

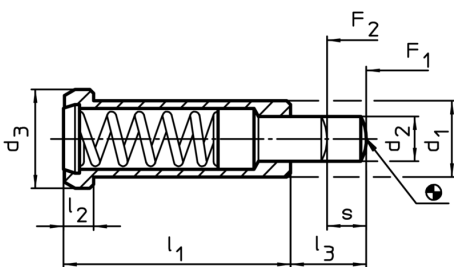

Order information

Dimensions						Stroke s [mm]	Spring load ¹⁾		max. [°C]	Location hole H7 [mm]	[g]	Art. No.
d ₁ -0,05	d ₂	d ₃	l ₁	l ₂	l ₃		F ₁ ~ [N]	F ₂ ~ [N]				
stainless steel, standard spring load												
12	7,9	16	36	5	12	6,5	50	130	250	12	27	22070.0112

¹⁾ statistical average value

Application example

