

## Ball Casters- screwable, plain bearing

22752.0061



### Product Description

For positioning and aligning of workpieces.  
Because of the slide bearing, the ball can roll permanently, and the surface of the workpiece is protected.  
At temperatures > 20°C, the carrying figure decreases linearly. (Example: at 90°C the load bearing capacity is max. 60%)

### Material

**Bearing**  
• plastic

**Ball**  
• Ball-bearing steel, hardened

**Screw**  
• Free cutting steel, blackened

### More information

### Notes

Special types on request.

### Drawing

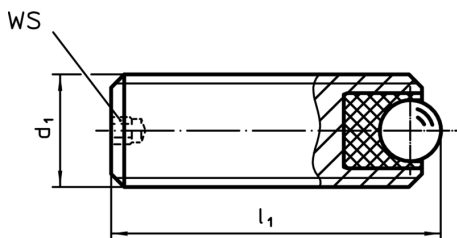

### Order information

Dimensions			WS	Load capacity for static load max.	Tightening torque max.	Temperature		Weight	Art. No.
d <sub>1</sub>	l <sub>1</sub>	Ball				min.	max.		
[mm]			[mm]	[N]	[Nm]	[°C]		[g]	
Free cutting steel									
M6	8	2,5	1,5	172	0,11	-50	90	1	22752.0061

### Application example

