

## Ball Casters- screwable, plain bearing

22752.0064



### Product Description

For positioning and aligning of workpieces.  
Because of the slide bearing, the ball can roll permanently, and the surface of the workpiece is protected.  
At temperatures  $> 20^{\circ}\text{C}$ , the carrying figure decreases linearly. (Example: at  $90^{\circ}\text{C}$  the load bearing capacity is max. 60%)

### Material

**Bearing**  
• plastic

**Ball**  
• Ball-bearing steel, hardened

**Screw**  
• Free cutting steel, blackened

### More information

### Notes

Special types on request.

### Drawing

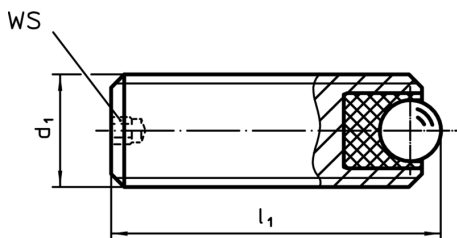

### Order information

Dimensions			WS	Load capacity for static load max.	Tightening torque max.	Temperature		Weight	Art. No.
$d_1$	$l_1$	Ball				min.	max.		
	[mm]		[mm]	[N]	[Nm]	[ $^{\circ}\text{C}$ ]		[g]	
<b>Free cutting steel</b>									
M6	16	2,5	1,5	172	0,11	-50	90	3	22752.0064

### Application example

