

Ball Casters· screwable, plain bearing

22752.0584



Product Description

For positioning and aligning of workpieces.
Because of the slide bearing, the ball can roll permanently, and the surface of the workpiece is protected.
At temperatures > 20°C, the carrying figure decreases linearly. (Example: at 90°C the load bearing capacity is max. 60%)

Material

Bearing
• plastic

Ball
• Stainless steel, hardened

Screw
• Stainless steel 1.4305

More information

Notes

Special types on request.

Drawing

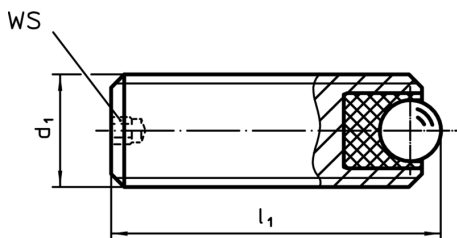

Order information

Dimensions			WS	Load capacity for static load max.	Tightening torque max.	Temperature		Weight	Art. No.
d ₁	l ₁	Ball				min.	max.		
[mm]			[mm]	[N]	[Nm]	[°C]		[g]	
stainless steel									
M8	20	3,5	1,5	336	0,28	-50	90	7	22752.0584

Application example

