

Ball Casters- screwable, plain bearing

22752.0666



Product Description

For positioning and aligning of workpieces.
Because of the slide bearing, the ball can roll permanently, and the surface of the workpiece is protected.
At temperatures > 20°C, the carrying figure decreases linearly. (Example: at 90°C the load bearing capacity is max. 60%)

Material

Bearing
• plastic

Ball
• Stainless steel, hardened

Screw
• Stainless steel 1.4305

More information

Notes

Special types on request.

Drawing

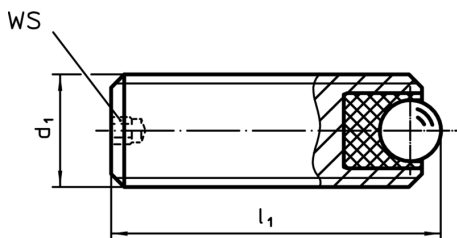

Order information

d ₁	Dimensions		WS [mm]	Load capacity for static load max. [N]	Tightening torque max. [Nm]	Temperature		Weight [g]	Art. No.
	l ₁ [mm]	Ball				min. [°C]	max.		
stainless steel									
M16	50	8,5	3	1986	3,21	-50	90	71	22752.0666

Application example

